

**FIU**

---

**Operations  
and Safety**

**Environmental Health & Safety**

Presents:

**2022 Laboratory Self Audit**



**Operations  
and Safety**

**Environmental Health & Safety**

# 2022 LSA

## Contact information

- All LSA questions and concerns should be directed to [EHS@FIU.EDU](mailto:EHS@FIU.EDU)
  - Managed by EH&S Director (Tamece Knowles) and distributed accordingly.



**Victoria Villa**

Laboratory Safety Officer

---

**Phone:** 305-348-7625

**Email:** [vmvilla@fiu.edu](mailto:vmvilla@fiu.edu)



**Gina Oubrar**

Assistant Director

---

**Phone:** 305-348-6849

**Email:** [gigallia@fiu.edu](mailto:gigallia@fiu.edu)



Operations  
and Safety

Environmental Health & Safety

# 2022 LSA

## Objectives:

- Participation Requirements
- Timeline and How to Access
- Support Features
- Question and Answer Session
  
- Contact Information
- Reminders
- Upcoming Events/Webinars



## Participation Requirements:

- Locations required to participate:
  - Laboratories, Support Spaces, Hazardous Storage/Stockrooms, Shops, etc.
    - Even if you do not have a hazard, the space is required to fill out the LSA; it is designed to end early if no significant hazards are in the space.
    - If you are unsure if the space is required, contact [ehs@fiu.edu](mailto:ehs@fiu.edu)
  - Office Spaces are not designed to hold/store hazards. Do not submit and LSA for an Office Space.
- Failure to complete the 2022 LSA could lead to a temporary closure of lab space.

## Requirements:

- Shared Spaces, Open Concepts and Annexes

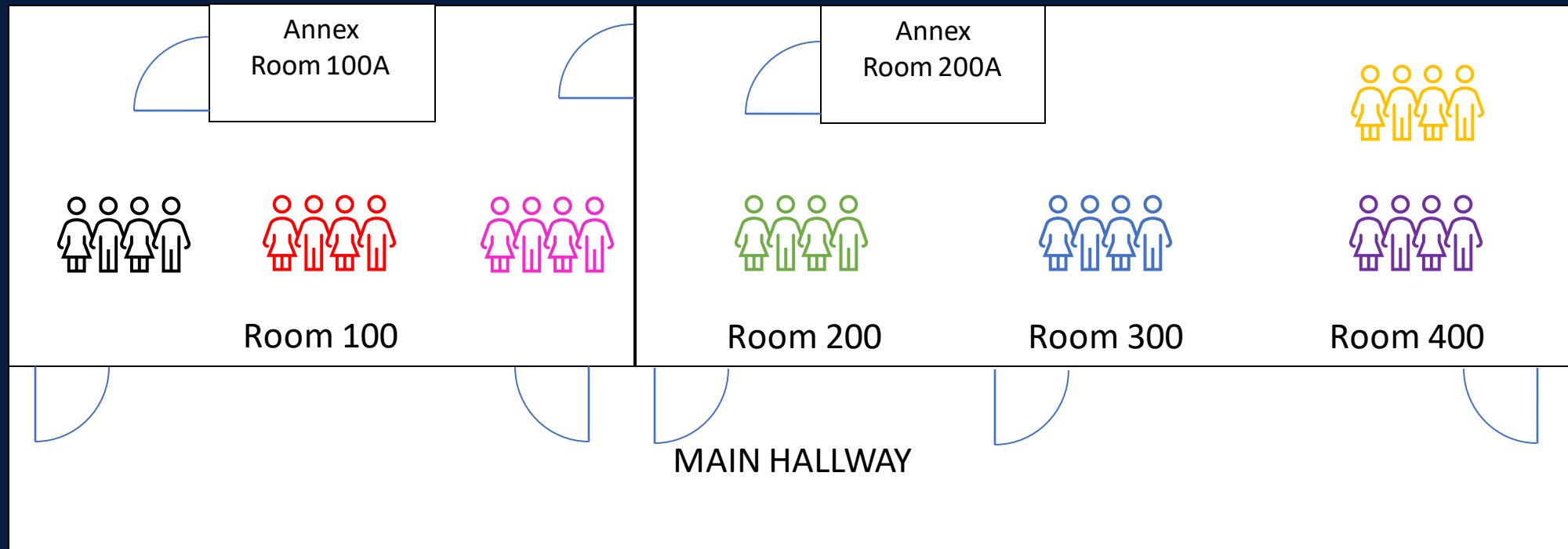



## Participation Requirements:

- Who is Authorized to Participate?
  - Group Leads/Heads (Principal Investigators, Lab Managers) and Lab Staff.
  - They MUST have the knowledge of all hazards present and operations conducted in the space.
  - NO Students, Volunteers, or Interns are permitted to participate.
    - EH&S will reject the submission.
- Group Heads must fill out the LSA or appoint someone within their group to submit on their behalf.
  - If you are unsure, contact your group head.



## Participation Requirements:

- Submissions EH&S will reject
  - Duplicate Submissions for the same group & same space
    - EH&S will reach out to all contacts and request a consolidation.
  - Not utilizing FIU email address
    - EH&S will reject the submission and require an FIU Email Address
- Unauthorized Participants (Student/Interns/Volunteers usually end in [###@fiu.edu](mailto:###@fiu.edu)). It is possible to be an FIU employee and a student; make sure the FIU Employee email is utilized.
  - EH&S will reject the submission and contact the department head/chair, group head, and the student/intern/volunteer through an encrypted email to ensure adherence with the Family Educational Rights and Privacy Act.



**Operations  
and Safety**

**Environmental Health & Safety**

# 2022 LSA

## **Timeline and How to Access LSA**

- Timeline: August 30<sup>th</sup> to November 30<sup>th</sup>
- Access Point
  - EHS Website: [ehs.fiu.edu](https://ehs.fiu.edu) > Safety Programs > Laboratory > Lab Self-Audit



Environmental Health and Safety

About Safety Programs Training Resources Announcements Report

WORK SAFETY

Regulations

Protection

Hazards

Risks

Safety first

Workpl

**FIU Coronavirus Advisory**  
Visit our Panthers Protecting Panthers website and our Federal Relief website for updates.

### Your Partner in Environmental and Safety Management

The mission of Environmental Health and Safety (EH&S) is to support and guide the university community in protecting our people, environment and property while assuring regulatory compliance. These programs are designed to provide value-added services with a customer-oriented, educational and collaborative approach for all students, faculty, staff and visitors to better live, learn, teach, work and visit a safe, environmentally friendly campus.

#### Safety Programs

EH&S supports a range of safety

#### Training

To ensure that members of the FIU

#### Report a Concern

See a potential hazard or have a



Operations  
and Safety

Environmental Health & Safety

# 2022 LSA

## Support Features:

- LSA Preview
- LSA Checklist
- Confirmation Email
  - Response Summary
  - Retake as a New Response \*FOR MULTIPLE SPACES\*
  - Feedback Survey



Environment

FIU EH&S 2021 Laboratory Self Audit Submitted:MM-C, AHC-4, 124 - Message (HTML)

File Message Developer Help

Delete Archive Reply Reply All Forward Share to Teams

Inbox To Manager Done Create New

Team Email

Reply & Delete

Move

Mark Unread Categorize Follow Up

Read Aloud Immersive Reader

Translate Zoom Phish Alert

FIU EH&S 2021 Laboratory Self Audit Submitted:MM-C, AHC-4, 124



FIU EH&S LSA 2021 <noreply@fiu.edu>  
To: Victoria Villa

Reply Reply All Forward

Thu 9/30/2021 3:56 PM

Note: This message originated from outside the FIU Faculty/Staff email system.



Greetings,

Thank you for submitting the 2021 Laboratory Self Audit for: MM-C, AHC-4, 124. Included in this email is a summary of your response; please review it and ensure the information is correct. If this submission requires any corrections, please email [ehs@fiu.edu](mailto:ehs@fiu.edu) to receive a link to edit the response.

**Multiple Spaces** to submit? The link below is a **retake as a new response** link that will duplicate the original responses into a new submission. Simply click on the link below and a new submission will be generated; make all the edits necessary before submitting it (i.e., changing the room number, the hazards found in the space, contact information, etc).

Retake as a New Response Link: [https://proxy.qualtrics.com/proxy/?url=https%3A%2F%2Ffiu.qualtrics.com%2Fjfe%2Fform%2FSV\\_5Bj8mCq4XrSy1Xo%3FQ\\_R%3DR\\_31AwfjrBMdeJdOw&token=fxthOdpbRLv2qnczXb6bP2UKcinW2s7uF8JYTiVhbIE%3D](https://proxy.qualtrics.com/proxy/?url=https%3A%2F%2Ffiu.qualtrics.com%2Fjfe%2Fform%2FSV_5Bj8mCq4XrSy1Xo%3FQ_R%3DR_31AwfjrBMdeJdOw&token=fxthOdpbRLv2qnczXb6bP2UKcinW2s7uF8JYTiVhbIE%3D)

If you have any questions or concerns, please reach out to EH&S by email [ehs@fiu.edu](mailto:ehs@fiu.edu).

Take part in our feedback survey! EH&S is always looking to improve the LSA and is interested in the insight you can provide. The feedback survey is completely anonymous and used to make modifications. [https://proxy.qualtrics.com/proxy/?url=https%3A%2F%2Ffiu.qualtrics.com%2Fjfe%2Fform%2FSV\\_72uQjdZ8LOElmBE&token=j%2BCxIDLrc6dhSYnhFoghC3JdCAnKhNzi05SKC6RyQjI%3D](https://proxy.qualtrics.com/proxy/?url=https%3A%2F%2Ffiu.qualtrics.com%2Fjfe%2Fform%2FSV_72uQjdZ8LOElmBE&token=j%2BCxIDLrc6dhSYnhFoghC3JdCAnKhNzi05SKC6RyQjI%3D)

[Download as PDF](#)

[URL to view Results](#)

[\[Click Here\]](#)

Response Summary:

## Question and Answer Session



**Operations  
and Safety**

**Environmental Health & Safety**

# 2022 LSA

## Contact information

- All LSA questions and concerns should be directed to [EHS@FIU.EDU](mailto:EHS@FIU.EDU)
  - Managed by EH&S Director (Tamece Knowles) and distributed accordingly.



**Victoria Villa**

Laboratory Safety Officer

---

**Phone:** 305-348-7625

**Email:** [vmvilla@fiu.edu](mailto:vmvilla@fiu.edu)



**Gina Oubrar**

Assistant Director

---

**Phone:** 305-348-6849

**Email:** [gigallia@fiu.edu](mailto:gigallia@fiu.edu)



## Reminders

- Online request for:
  - Stage-of-Use Compressed Gas Cylinder Tags
  - Hazardous Waste Labels
  - Sink Stickers Restricting the Discharge of Chemicals
- Go to [ehs.fiu.edu](https://ehs.fiu.edu) > Resources > Sticker/Label/Tag Request
- EH&S Newsletter
  - Every other month provides information about initiatives, programs, upcoming events
  - Go to [ehs.fiu.edu](https://ehs.fiu.edu) > Resources > EH&S Newsletter



Environmental Health and Safety

About Safety Programs Training Resources Announcements Report

## WORK SAFETY

Regulations Protection Hazards Risks Safety first Workpla

**FIU Coronavirus Advisory**  
Visit our Panthers Protecting Panthers website and our Federal Relief website for updates.

### Your Partner in Environmental and Safety Management

The mission of Environmental Health and Safety (EH&S) is to support and guide the university community in protecting our people, environment and property while assuring regulatory compliance. These programs are designed to provide value-added services with a customer-oriented, educational and collaborative approach for all students, faculty, staff and visitors to better live, learn, teach, work and visit a safe, environmentally friendly campus.

**Safety Programs**  
EH&S supports a range of safety

**Training**  
To ensure that members of the FIU

**Report a Concern**  
See a potential hazard or have a



## Upcoming Events

- **Zoom Webinar: Review the new EH&S Chemical Inventory System**
  - August 24<sup>th</sup> (Wednesday) @ 1:30pm
- **Zoom Webinar: Review the Hazardous Waste and Satellite Accumulation Area Policies and Procedures at FIU**
  - September 1<sup>st</sup> (Thursday) @ 1:30pm
- Links have been sent through the FIU Laboratory ListServ. If you have not received the email, please email [ehs@fiu.edu](mailto:ehs@fiu.edu) and request to be added.



**FIU**

---

**Operations  
and Safety**

**Environmental Health & Safety**

**2022 Laboratory Self Audit**